

# Property Report for Parcel#: 954768

Tuesday, September 26, 2017

## Parcel Information

Address:	THORNTON CREEK LN CLE ELUM
Tax Parcel ID:	<a href="#">954768</a>
Map Number:	19-16-08059-0002
Recorded Area:	3.15 a
Owner Name	STEINBERG, MICHAEL & ELLEN
Name Cont:	
Mailing Address:	7009 S 129TH PL
City/State/Zip:	SEATTLE WA 98178-4711

## Critical Areas Information

Contains > 30% Slope:	Yes
PHS Site Name:	N/A
Roof Hazard:	HIGH_EXTREEME HAZARD RATING
Roof Class:	CLASS A
Seismic Category:	D1
Shore Line:	N/A
Wetland Code:	N/A
DNR Water Type:	N/A
FIRM Zone:	ZONE C
FEMA Flood Map:	5300950264B
Coalmine Shaft:	N/A
Airport Zone:	N/A
BPA Right of Way:	N/A
Max Elevation:	2564
ISO:	0.053
PG:	136, <a href='http://www.co.kittitas.wa.us/boc/co_unitycode/title14.aspx#14.04.020' target='_blank'>Engineering is required</a>

## Domestic Water Information

Groundwater Permit Required?	No, <a href="#">Suitability Map</a>
Qualifying Water Banks:	Big Creek WR, Bourne, Burchak, KittitasCnty(Clennon), KittitasCnty (Roth), Masterson, New Suncadia, Northland Resources, Roan New Suncadia, Swiftwater Ranch, Western Water Partners, Yakima Mitigation Services
Sub Basin Watershed:	Kachess Yakima River

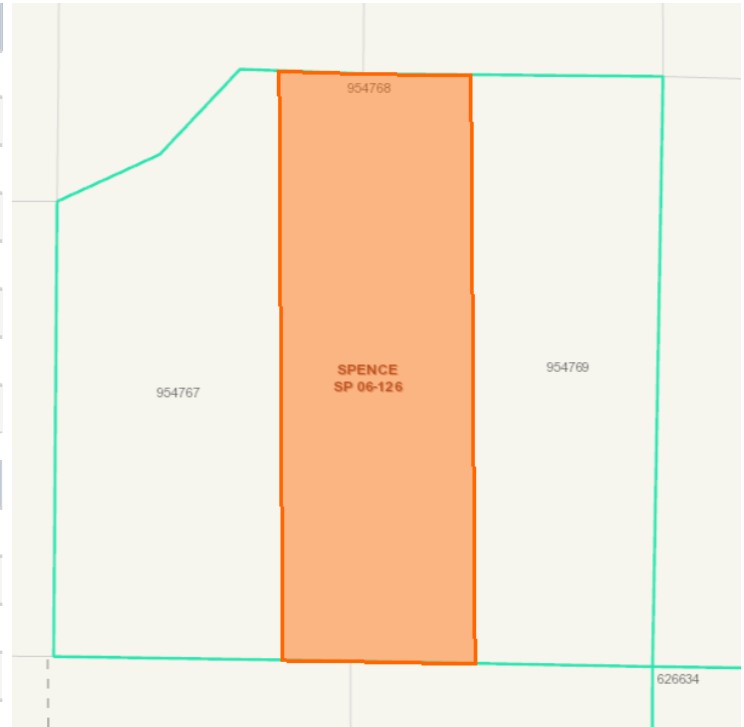

## Administrative Information

Zone and Allowed Uses:	<a href="#">Rural 5</a>
Land Use Category:	Rural Residential
Commisioner District:	2
Voter Precinct:	Peoh Point
Hospital District:	HOSPITAL DISTRICT 2
School District:	Cle Elum-Roslyn School District
Irrigation District:	N/A
Weed District:	Weed District #9
Fire District:	Fire District 7 (Cle Elum)
Cemetery District:	N/A
Court District:	Upper District Court
PUD Comm District:	District 2
Parks and Rec District:	District 1
Wildland Urban Interface:	<a href="#">IR 1</a>
COE Gas Service Area:	No